

NEW PRODUCT PRE-INSULATED PI-ANCHOR SERIES

PATENT PENDING

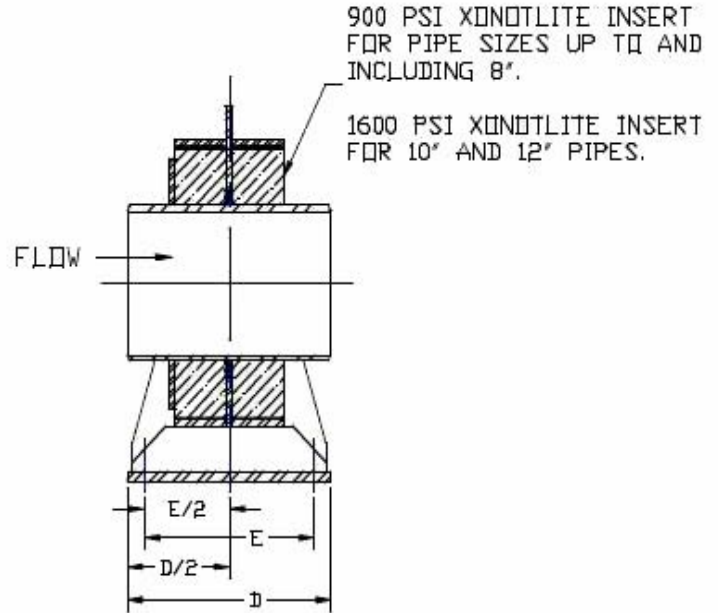

PIPE SIZE (NOM. ID, INCHES)	ANCHOR ASSEMBLY PART NUMBER	THRUST LOAD MAXIMUM LBS FORCE	DIM A	DIM B	DIM C	DIM D	DIM E	DIM F	DIM G	DIM H
1 1/2	PI-AN-A-01.50	2,200	5.56	12.12	10.00	8.00	6.00	5.62	5.00	0.62
2	PI-AN-A-02.00	2,200	5.31	12.12	10.00	8.0	6.00	5.62	5.00	0.62
2 1/2	PI-AN-A-02.50	5,750	5.62	13.68	12.00	8.00	6.00	6.62	7.00	0.62
3	PI-AN-A-03.00	5,750	5.31	13.68	12.00	8.00	6.00	6.62	7.00	0.62
4	PI-AN-A-04.00	7,150	5.31	14.62	12.75	10.00	8.00	7.06	8.00	0.88
5	PI-AN-A-05.00	9,100	5.31	15.75	14.00	10.00	8.00	7.69	9.00	0.88
6	PI-AN-A-06.00	12,800	5.38	17.38	16.00	12.00	10.00	8.69	11.00	0.88
8	PI-AN-A-08.00	17,500	6.81	21.00	18.75	12.00	10.00	10.06	13.00	1.12
10	PI-AN-A-10.00	24,500	7.00	24.38	22.50	20.00	16.00	12.00	15.00	1.62
12	PI-AN-A-12.00	30,500	7.18	26.50	24.50	22.00	18.00	12.94	17.00	1.62

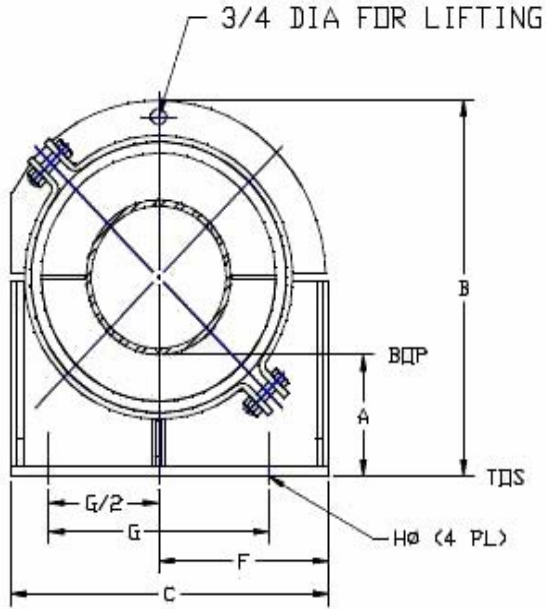

Tri-State Industries, Inc.
4923 Columbia Avenue, Hammond, IN 46327
Phone: 219-933-1710 Fax: 219-933-1719



Pre-Insulated Anchor Submittal Drawing

Approved by:
DEK

Date:
10/14/05

Tolerance

2 Place +/- Fract. +/- 1/16
3 Place +/- Angular +/-

Material: Carbon Steel
Finish: Powder Coat

Drawing Number:
PI-AN-S REV: 2